



Welcome
Session C5- Tourism Planning:
Tribal Tourism Funding Opportunities Panel
Thursday, September 20, 2018
10:45am – 12:15pm

To receive a Certificate of Completion, please provide information requested in the session sign-in sheet for each session attended



AIANTA
American Indian Alaska Native
Tourism Association



**The NATIVE Act and the Smithsonian
National Museum of the American Indian**

Sec. 5 – Federal Agencies Compliance

- Support tribes and Native Hawaiian organizations in showcasing their history and culture
- Assist in interpreting connections between Native Americans and the national identity of the US
- Enhance efforts to promote understanding and respect for diverse US cultures
- Ensure that travelers are welcomed in a manner that showcases and respects the diversity of Native American communities

Smithsonian Institution

- Must work with tribes and Native Hawaiian organizations, and nonprofits
 - To share collections
 - Conduct joint research and projects with museums
 - Educational organizations
 - Cultural organizations

National Museum of the American Indian

- Designated SI museum to implement the NATIVE Act
 - What are we doing to comply with this directive?
 - Strategic Plan
 - Public Programs
 - Exhibitions
 - Collections
 - National Education Initiative
 - Native American Veterans Memorial

Washington, D.C.



Suitland, Maryland



New York, NY

Strategic Plan

- The NMAI has developed a 5 year strategic plan
 - Increase visitorship
 - Host a minimum of 4 seminars/symposia on current topics in Indian country
 - Improve outreach efforts
 - National Education Initiative

Public Programs

- Tribal festivals
- Chocolate Festival
- Hawaiian Festival
- Living Earth Festival
- Day of the Dead
- Art Market

Celebrating Cacao/Chocolate



NATIONAL
MUSEUM
OF THE
AMERICAN
INDIAN



Informative Sessions

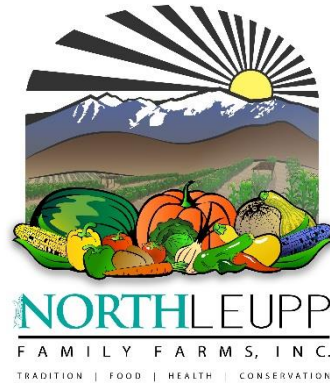

Family Fun for All



Cherokee Days



Collections



- <http://www.nmai.si.edu/explore/collections/>

National Education Initiative



- <http://www.nmai.si.edu/nk360/>

Native American Veterans Memorial

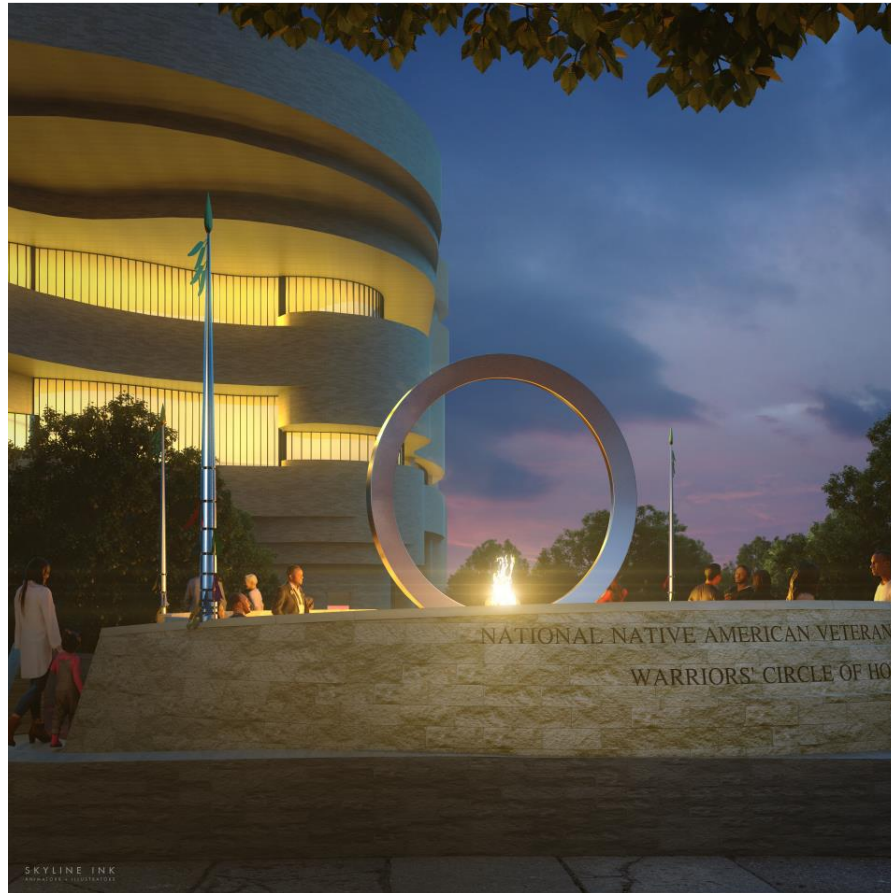

- <https://nmai.si.edu/nnavm/>

NATIONAL
MUSEUM
■ OF THE ■
AMERICAN
INDIAN

Carolyn McClellan

1.202.633.6710; cell 202.253.2356

mcclellanc@si.edu

Shawn Termin

1.202.633.6628; cell 202.286.0512

termins@si.edu

www.AmericanIndian.si.edu